

SUITE 2050

BUILDING
222 W ADAMS

FLOOR
20

RSF
10,722

GET IN TOUCH

Ellen May

312.669.8133

EMay@TishmanSpeyer.com

Carey Spignese

312.669.8105

CSpignes@TishmanSpeyer.com



TISHMAN SPEYER

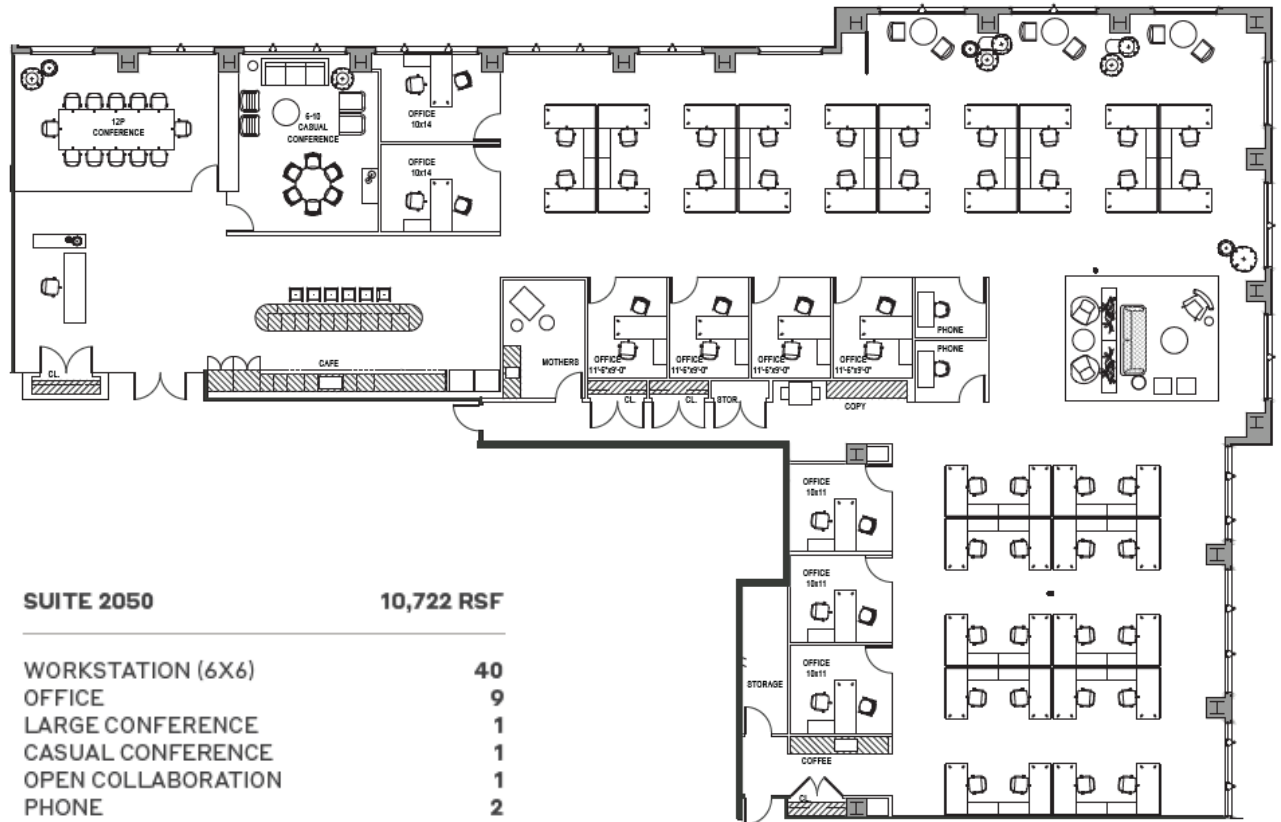

SUITE 2050 **10,722 RSF**

WORKSTATION (6X6)	40
OFFICE	9
LARGE CONFERENCE	1
CASUAL CONFERENCE	1
OPEN COLLABORATION	1
PHONE	2
CAFE	1
MOTHERS ROOM	1
COPY	1
STORAGE	2
CLOSET	4
COFFEE	1

KEY PLAN

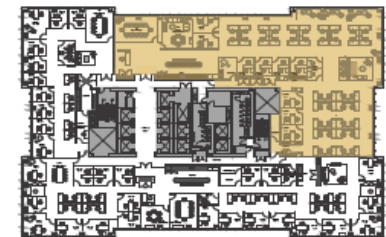

AMENITY BROCHURE

AMENITY VIDEO